



# INSTRUCTION BULLETIN

No. 9018921  
Machine: M17  
Published: 03-2023  
Rev. 00

**NOTE: DO NOT DISCARD the Parts List from the Instruction Bulletin. Place the Parts List in the appropriate place in the machine manual for future reference. Retaining the Parts List will make it easier to reorder individual parts and will save the cost of ordering an entire kit.**

*NOTE: Numbers in parenthesis ( ) are reference numbers for parts listed in Bill of Materials.*

Installation instructions for **kit number 9018840**

Kit installation must be performed by TennantTrue<sup>®</sup> service or an authorized service provider.

## SYNOPSIS:

This kit contains the parts needed to replace direct throw sweep skirts onto M17 sweeper scrubbers  
Please follow step-by-step instructions.

## SPECIAL TOOLS / CONSIDERATIONS: NONE

(Estimated time to complete: 45 minutes)

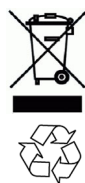

### PROTECT THE ENVIRONMENT

Please dispose of packaging materials, used machine components such as batteries and fluids in an environmentally safe way according to local waste disposal regulations.

Always remember to recycle.

## PREPARATION:

1. Completely raise the sweeping main brush and turn off the machine

**FOR SAFETY: Before leaving or servicing machine, stop on level surface, turn off machine, set parking brake, and remove key.**

## INSTALLATION:

1. Open the main sweeping brush compartment access door. (Fig. 2)



FIG. 1

2. Remove the yellow knobs securing the skirt side plate assembly and idler assembly to the machine. Set the yellow knobs aside. (Fig. 2/Fig. 3)

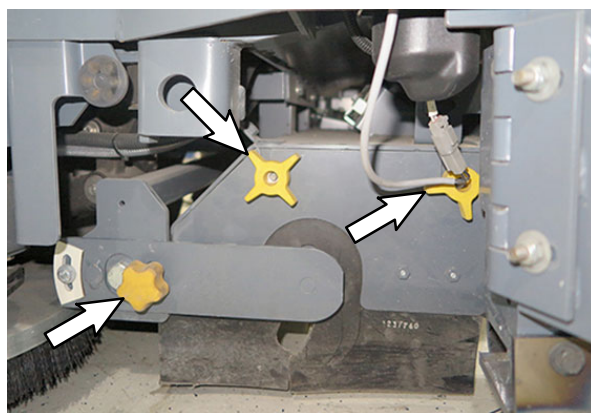
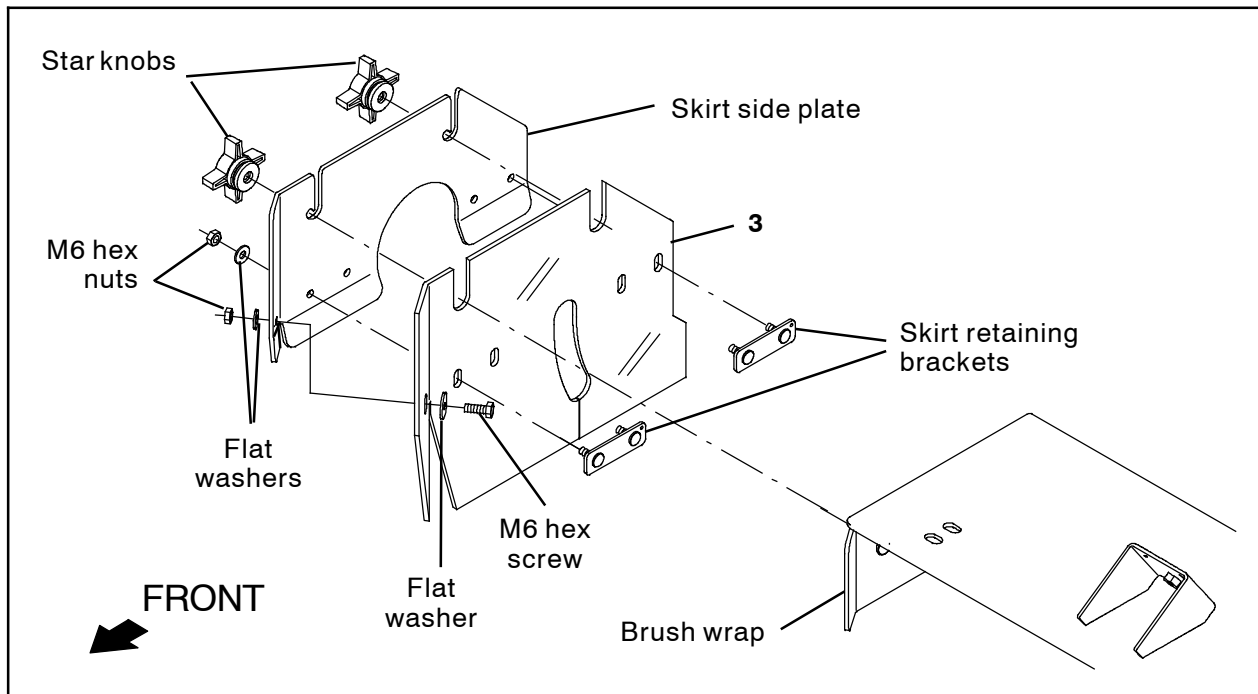

FIG. 2



**FIG. 3**

3. Remove the skirt side plate assembly and idler assembly from the machine. Set the idler assembly aside. (Fig. 3/Fig. 4/Fig. 5)



**FIG. 4**



**FIG. 5**

4. Remove the sweep brush from the sweep head. Set the sweep brush aside. (Fig. 6)



**FIG. 6**

5. Remove the idler skirt from the skirt side plate assembly. Set the hardware, skirt retaining brackets, and skirt side plate aside. Discard the removed idler skirt. (Fig. 3)
6. Use the saved hardware and skirt retaining brackets to install the new idler skirt (3) onto the skirt side plate. (Fig. 3)

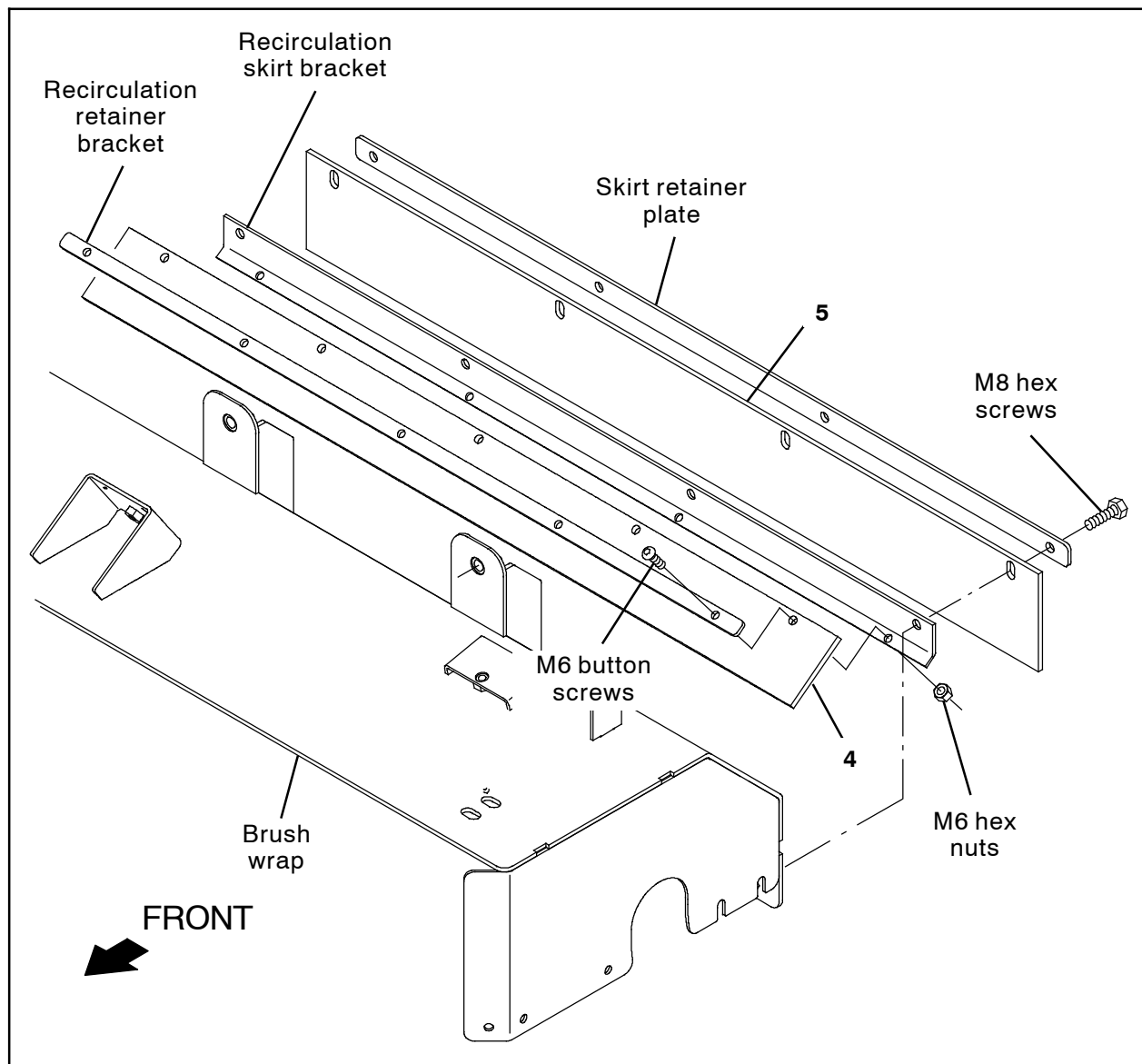

**FIG. 7**

7. Remove the recirculation skirt assembly from the brush wrap. Set the hardware and skirt retainer plate aside. Discard the rear skirt (Fig. 7)
8. Remove the recirculation retainer bracket from the recirculation skirt bracket. Set the hardware, recirculation retainer bracket, and recirculation skirt bracket aside. Discard the recirculation skirt. (Fig. 7)
9. Use the saved hardware and recirculation retainer bracket to install the new recirculation skirt (4) onto the recirculation skirt bracket. (Fig. 7)
10. Use the saved hardware and the skirt retainer plate to install the new rear skirt (5) and rest of the recirculation skirt assembly onto the brush wrap. (Fig. 7)

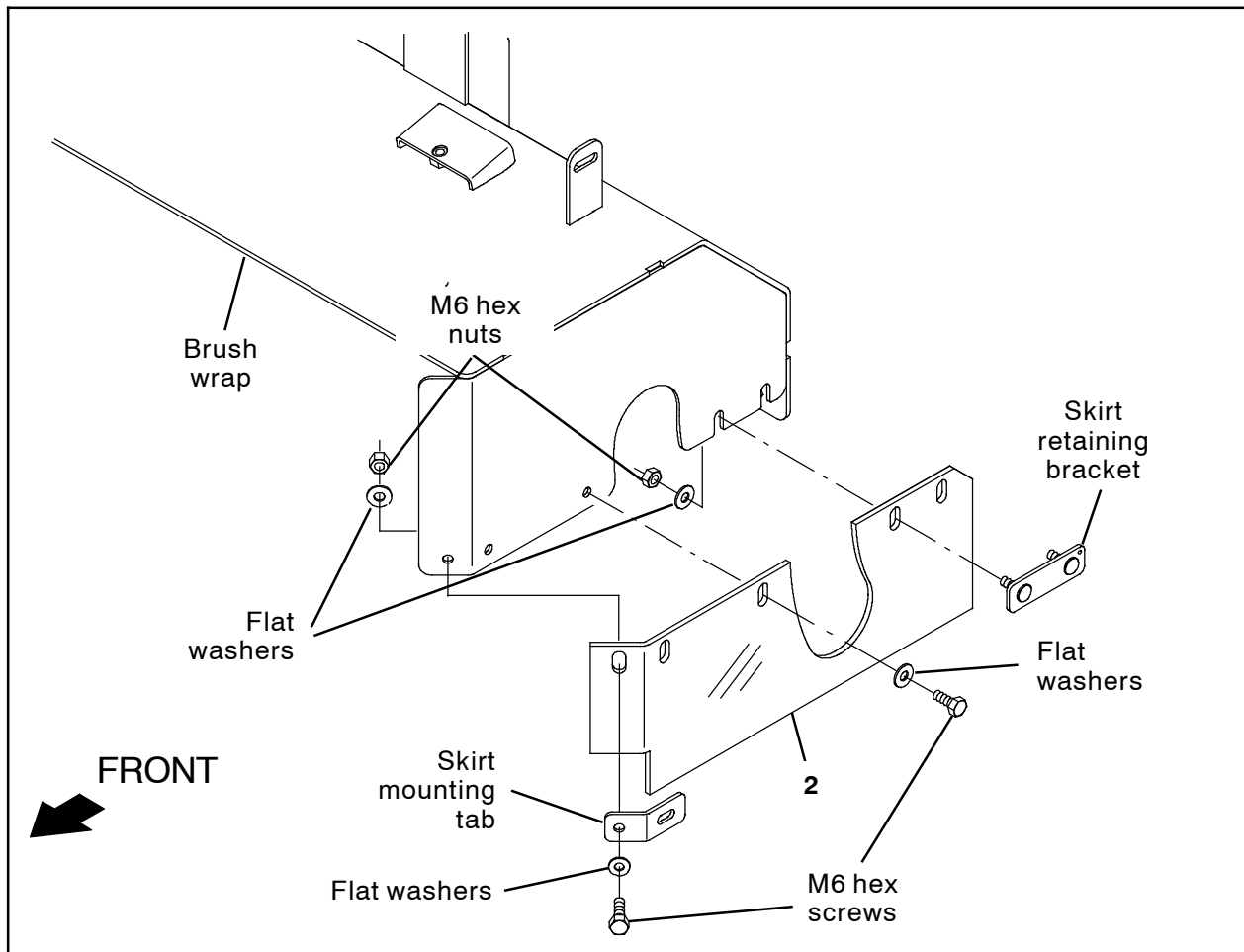

**FIG. 8**

11. Remove the left brush cover panel from the machine. Set the left brush cover panel and mounting hardware aside. (Fig. 9)

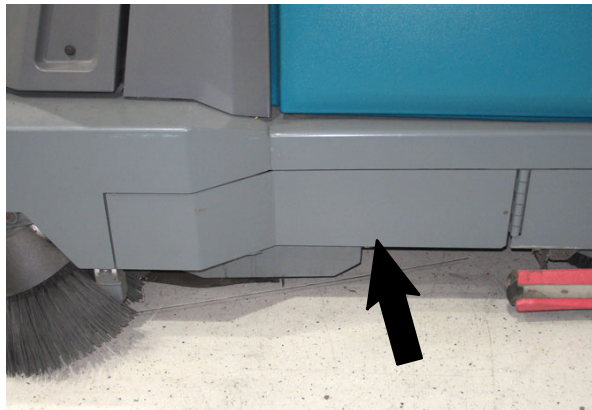

**FIG. 9**

12. Remove the left skirt from the brush wrap. Set the hardware, skirt retaining bracket, and skirt mounting tab aside. Discard the left skirt. (Fig. 8)

13. Use the saved hardware, skirt retaining bracket, and skirt mounting tab to install the new left skirt (2) onto the brush wrap. (Fig. 8)

14. Reinstall the left brush cover panel onto the machine.

15. Reinstall the sweep brush skirt side plate assembly, and idler assembly onto the machine.

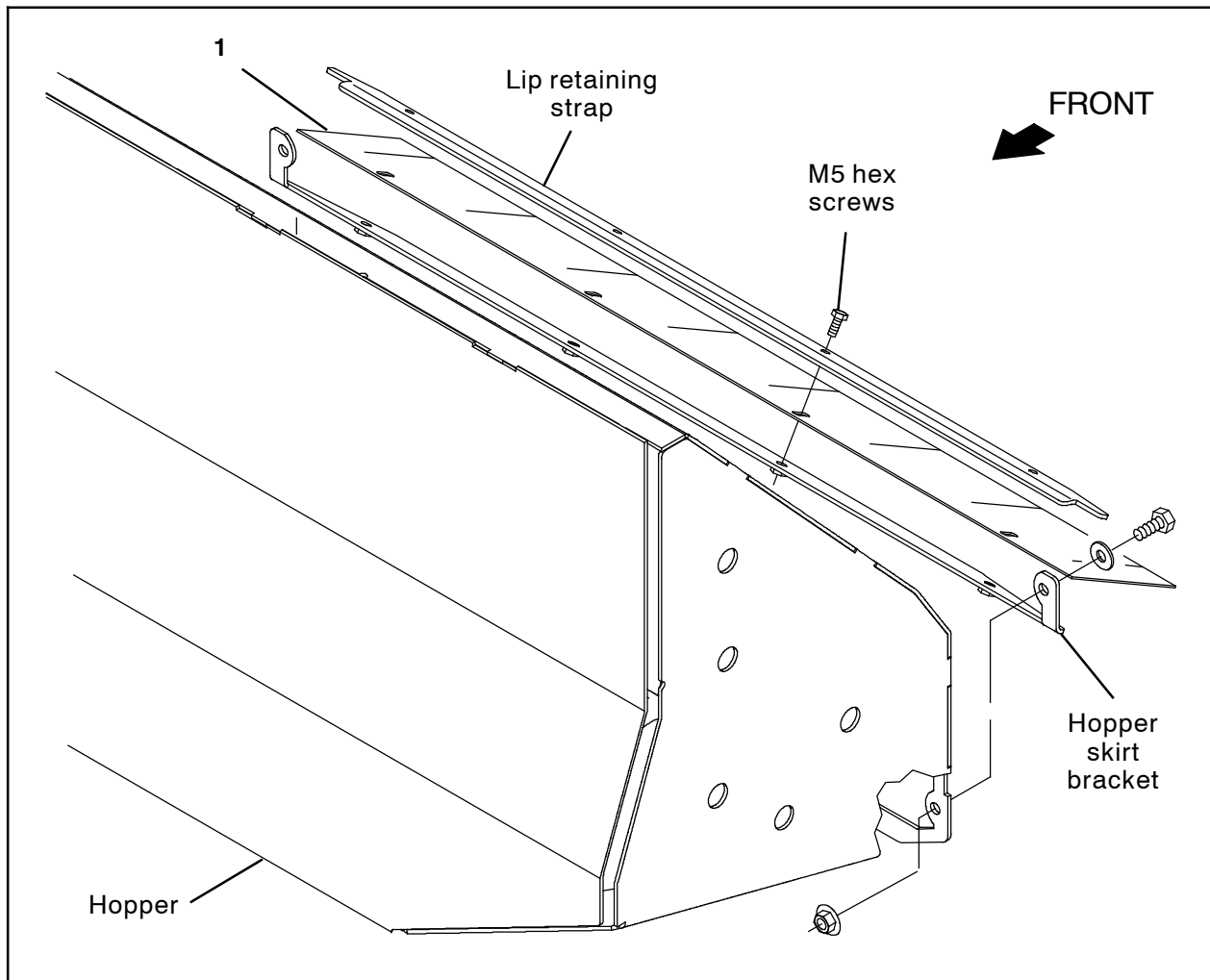

**FIG. 10**

16. Turn on the machine, completely raise the hopper, turn off the machine, position the hopper support bar onto the support bar stop, turn on the machine, and slowly lower the hopper until the hopper support bar rests on the support bar stop.

**WARNING:** Lift arm pinch point. Stay clear of hopper lift arms.

**WARNING:** Raised hopper may fall. Engage hopper support bar.

17. Turn off the machine.

18. Remove the front skirt from the hopper skirt bracket. Set the lip retaining strap and hardware aside. Discard the front skirt. (Fig. 10)

19. Use the lip retaining strap and the saved hardware to install the new front skirt onto the hopper skirt bracket. (Fig. 10)

20. Turn on the machine, completely raise the hopper, turn off machine, disengage the hopper support bar, turn on the machine, and completely lower the hopper.

21. Test the machine. Operate the machine in the sweep mode. Watch for excessive dusting. Adjust new installed skirts as necessary.

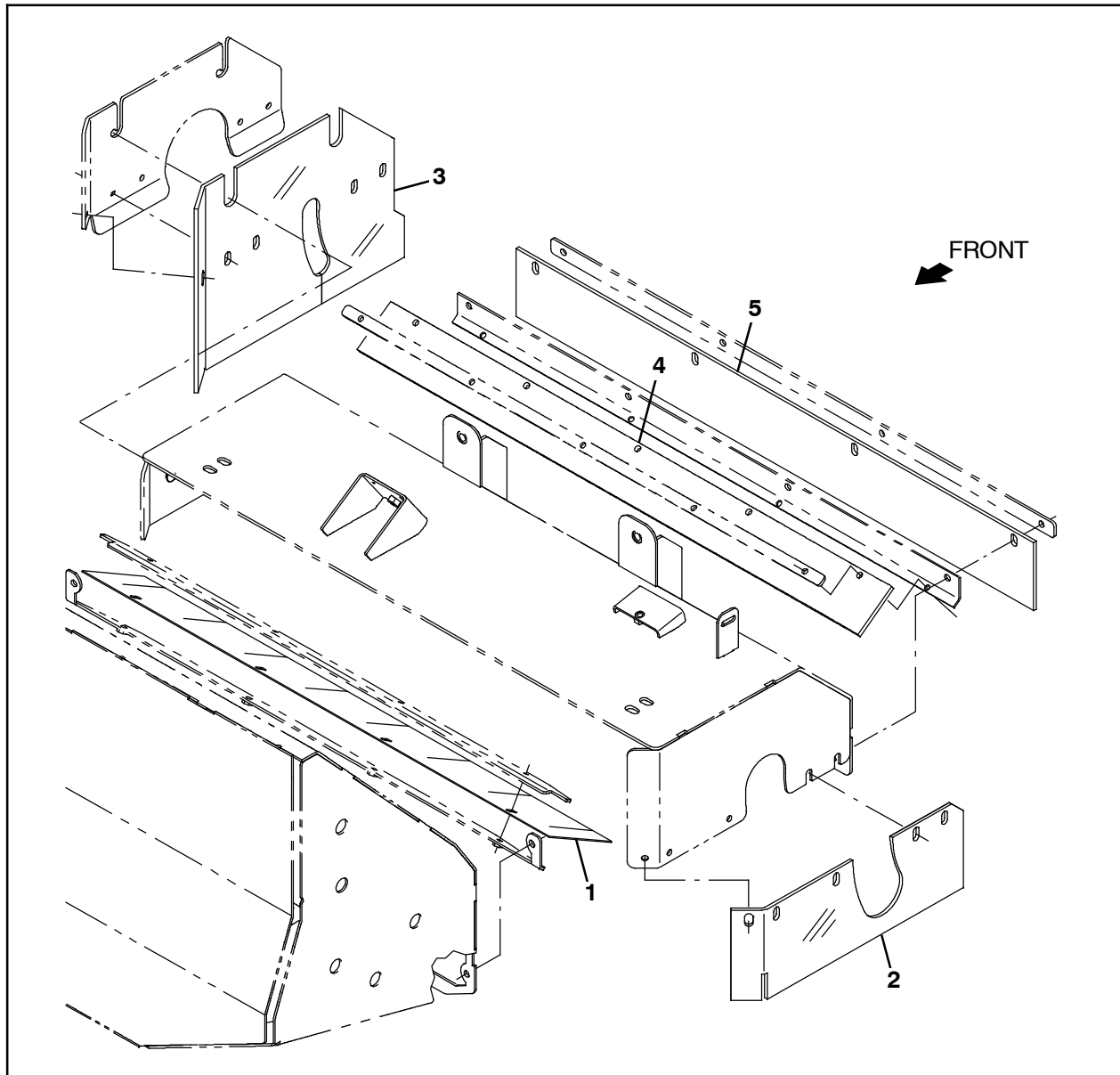

FIG. 11

**Bill Of Materials For Skirt Kit, Swp, Direct, Afmkt [M17] - 9018840**

Ref.	Tennant Part No.	Description	Qty.
1	1238256	Skirt, Front	1
2	1238251	Skirt, LH	1
3	1237760	Skirt, Idler	1
4	1231251	Skirt, Recirculation	1
5	1227117	Skirt, Rear	1

TENNANT COMPANY  
10400 Clean Street  
Eden Prairie, MN 55344- 2650